

HAPCO
Flex Connectors
Flanged X Flanged

PART NUMBER	DWG #	SIZE	A PIPE SIZE (O.D.)	B	C	D	E (I.D.)	F
HSPF	3600A-1	1.5	1.5	1.5	15	18	1.375	5
HSPF	3601A-1	2	2	1.5	15	18	1.875	6
HSPF	3602A-1	2.5	2.5	1.5	15	18	2.375	7
HSPF	3603A-1	3	3.5	1.5	15	18	3	7.5
HSPF	3604A-1	3.5	4	1.5	15	18	3.5	8.5
HSPF	3605A-1	4	4.5	1.5	15	18	4	9
HSPF	3606A-1	5	5.563	1.5	15	18	5	10
HSPF	3607A-1	6	6.625	1.5	15	18	6	11
HSPF	3608A-1	8	8.625	1.5	15	18	8	13.5
HSPF	3609A-1	10	10.75	1.5	15	18	10	16
HSPF	3610A-1	12	12.75	1.5	15	18	12	19
HSPF	3611A-1	14	14	1.5	15	18	13.25	21
HSPF	3612A-1	16	16	1.75	14.5	18	15.25	23.5
HSPF	3613A-1	18	18	1.75	14.5	18	17.25	25
HSPF	3614A-1	20	20	1.75	14.5	18	19.25	27.5
HSPF	3615A-1	22	22	2.5	13	18	21.25	29.5
HSPF	3616A-1	24	24	2.5	13	18	23.25	32
HSPF	3617A-1	26	26	2.5	13	18	25.25	34.25
HSPF	3618A-1	28	28	2.5	13	18	27.25	36.5

*For price information see Section 2 Page 10

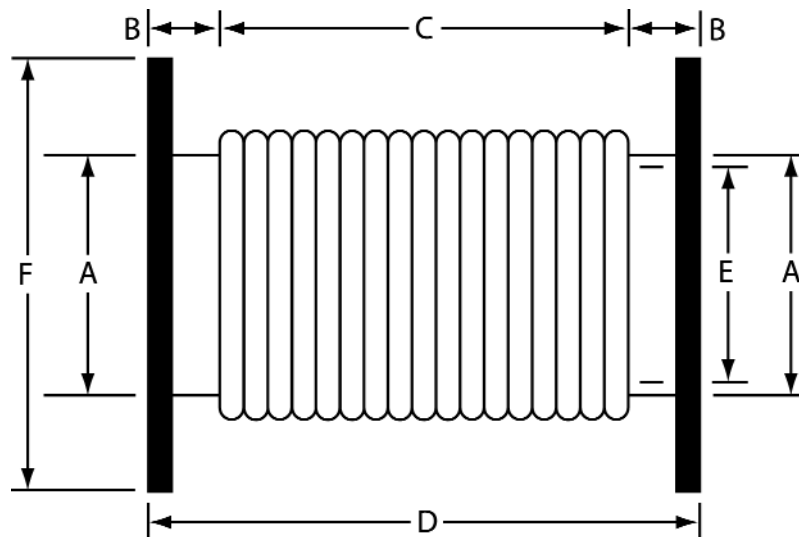

Features:

- For each additional inch multiply list X 3%
- Single-ply T 321 stainless steel flex
- Stubs and flanges are carbon steel
- Optional features available:
 - Floating flanges
 - Stainless steel liners

Accessories:

- Gaskets
- Fasteners
- High Temp Blankets
- Nuts & Bolts